



BUILDING AMERICA®

308216

ENTERED  
Office of Proceedings  
April 16, 2024  
Part of  
Public Record

April 16, 2024

**Via E-Filing**

Ms. Cynthia T. Brown Chief, Section of Administration  
Office of Proceedings  
Surface Transportation Board  
395 E Street SW  
Washington, D.C. 20423-0001

Re: **Proposed Abandonment of the Rock Island Old Passenger Main near Olivette, St. Louis County, MO, STB Docket No. AB-33 (Sub-No. 350X), Union Pacific Railroad Company**

**Proposed Discontinuance of Service on the Rock Island Old Passenger Main near Olivette, St. Louis County, MO, STB Docket No. AB 1338X, Missouri Eastern Railroad, LLC**

Dear Ms. Brown:

Pursuant to the Board's exemption procedures under 49 C.F.R. § 1152.50, enclosed for electronic filing in Docket No. AB-33 (Sub-No. 350X) and Docket No. AB 1338X is a Joint Verified Notice of Exemption for Union Pacific Railroad Company to abandon, and for Missouri Eastern Railroad, LLC to discontinue service over, respectively, approximately .55 miles of the Rock Island Old Passenger Main from MP 11.58 to MP 11.03 in St. Louis County, Missouri. The filing fees for these two proceedings, totaling \$9,400.00, have been paid via pay.gov.

Please feel free to contact me if you have any questions.

Sincerely,

Christine A. Neuharth  
Senior General Attorney  
1400 Douglas St, MS1580  
Omaha, NE 68179  
402-544-4764 (Tel.)  
[caneuhar@up.com](mailto:caneuhar@up.com)

**FEE RECEIVED**  
**April 16, 2024**  
**SURFACE**

**FILED**  
**April 16, 2024**  
**SURFACE**  
**TRANSPORTATION BOARD**

**TRANSPORTATION BOARD**

**BEFORE THE  
SURFACE TRANSPORTATION BOARD**

---

**Docket No. AB-33 (Sub-No. 350X)  
UNION PACIFIC RAILROAD COMPANY  
-- ABANDONMENT EXEMPTION --  
IN ST. LOUIS COUNTY, MO**

**Docket No. AB 1338X  
MISSOURI EASTERN RAILROAD, LLC  
-- DISCONTINUANCE OF SERVICE EXEMPTION --  
IN ST. LOUIS COUNTY, MO**

---

**Joint Notice of Exemption**

UNION PACIFIC RAILROAD COMPANY  
Christine A. Neuharth  
Senior General Attorney  
1400 Douglas Street, MS 1580  
Omaha, NE 68179  
402-544-4764  
[caneuhar@up.com](mailto:caneuhar@up.com)

MISSOURI EASTERN RAILROAD, LLC  
Robert A. Wimbish  
Fletcher & Sippel LLC  
29 North Wacker Drive  
Suite 800  
Chicago, IL 60606  
(312) 252-1504  
[rwimbish@fletcher-sippel.com](mailto:rwimbish@fletcher-sippel.com)

Dated: April 16, 2024

**BEFORE THE  
SURFACE TRANSPORTATION BOARD**

---

**Docket No. AB-33 (Sub-No. 350X)  
UNION PACIFIC RAILROAD COMPANY  
-- ABANDONMENT EXEMPTION --  
IN ST. LOUIS COUNTY, MO**

**Docket No. AB 1338X  
MISSOURI EASTERN RAILROAD, LLC  
-- DISCONTINUANCE OF SERVICE EXEMPTION --  
IN ST. LOUIS COUNTY, MO**

---

**Joint Verified Notice of Exemption**

Union Pacific Railroad Company ("UP") and Missouri Eastern Railroad, LLC ("MER") (collectively, "the Railroads") jointly file this Verified Notice of Exemption pursuant to 49 C.F.R. § 1152, Subpart F-- Exempt Abandonments and Discontinuances of Service and Trackage Rights, for UP to abandon and for the MER to discontinue operations over that portion of the Rock Island Old Passenger Main extending from Milepost 11.58 to Milepost 11.03, near Olivette, in St. Louis County, Missouri (the "Line"). The stub-ended Line is a total distance of 0.55 miles ending at Milepost 11.03. The Line is subject to a Lease Agreement dated December 4, 2015, between UP, as lessor, and Central Midland Railway Company ("CMR"), as lessee. CMR subsequently assigned its leasehold interest in the Line to MER on February 28, 2022, with UP's consent. MER assumed leasehold possession of the Line on March 1, 2022.

**Proposed Consummation Date: 49 C.F.R. § 1152.50(d)(2)** The proposed abandonment and discontinuance of service will be consummated on or after the effective date of the subject class exemptions.

**Certification: 49 C.F.R. 1152.50(b)**

Each of the Railroads hereby certifies that no local or overhead traffic has moved over the stub-ended Line for at least two years. Therefore, there is no need to reroute any traffic. Each of the Railroads further hereby certifies that no formal complaint filed by a user of rail service on the Line (or filed by a state or local governmental entity acting on behalf of such user) regarding cessation of service over the Line is pending either with the Board or any U.S. District Court or has been decided in favor of the complainant within the two-year period.

**Additional Information Required: 49 C.F.R. 1152.22(a)(1)-(4), (7)-(8) and (e)(4)**

**(a) General.**

**(a)(1)** UP's exact name is Union Pacific Railroad Company. MER's exact name is Missouri Eastern Railroad, LLC.

**(a)(2)** Both UP and MER are common carriers by railroad subject to 49 U.S.C. Subtitle IV, Chapter 105.

**(a)(3)** UP has invoked the Board's class exemption procedures at 49 C.F.R. § 1152.50 to abandon the Line, comprised of a portion of the Rock Island Old Passenger Main extending from Milepost 11.58 to Milepost 11.03, near Olivette, in St. Louis County, Missouri. The stub-ended Line is a total distance of 0.55 miles ending at Milepost 11.03 (as previously defined, the "Line"). MER has invoked the same class exemption procedures to discontinue operations over the Line.

**(a)(4)** A map showing the location of the Line in relation to other rail lines, highways, and major roads in the area is attached as **Exhibit 1**.

**(a)(7)** The representatives to whom correspondence regarding these abandonment and discontinuance proceedings should be sent are as follows:



Attorney for Union Pacific Railroad Company

Christine A. Neuharth  
Senior General Attorney  
1400 Douglas Street, MS 1580  
Omaha, NE 68179  
402-544-4764  
[caneuhar@up.com](mailto:caneuhar@up.com)

Attorney for Missouri Eastern Railroad, LLC

Robert A. Wimbish  
Fletcher & Sippel LLC  
29 North Wacker Drive, Suite 800  
Chicago, IL 60606  
(312) 252-1504  
[rwimbish@fletcher-sippel.com](mailto:rwimbish@fletcher-sippel.com)

(a)(8) ZIP Codes. The Line traverses U.S. Postal Service Zip Code 63132.

(e)(4) Rural and Community Impact.

UPs intends to sell the right-of-way, track, ties, ballast, one bridge (located at Milepost 11.58), public road crossings, and railroad signals (all improvements), and assign any existing leases, licenses, or easements, to Metropolitan Park and Recreation District d/b/a The Great Rivers Greenway District, a corporate and political subdivision of the State of Missouri (the "Buyer"). To that end, UP and the Buyer have entered into a purchase and sale agreement under which the assembled corridor would be sold to Buyer to be re-deployed as a hike/bike trail. Culverts and right-of-way grading will remain intact so as not to alter the prevailing drainage and water flows along the Line. Ballast will typically be left in place but may be removed by the Buyer after the sale if it is of exceptional quality - thus suitable for resale.

All track, ties, public road crossings, and railroad signals will be salvaged and removed by a contractor engaged by the Buyer after consummation of the proposed

abandonment and completion of the sale. The Buyer also intends to remove the bridge superstructure, while the bridge abutment walls will generally remain in place. Buyer's contract for salvage and removal would include detailed information on any environmental or historical conditions imposed by the Board, if applicable.

Based on UP's records, UP holds fee title to the real property that comprises the right-of-way, and the Line does not contain federally granted right-of-way. Any documentation in UP's possession regarding UP's title to the Line will be made available to those requesting it.

No local traffic has moved over the Line during the past two years, and there is no overhead traffic or passenger service on the Line. The Railroads have received no request for rail service on the Line in well over two years. No complaint regarding cessation of service has been filed, is pending, or has been ruled upon in favor of a complainant during the prior two years.

A map of the Line is attached hereto as **Exhibit 1**.

### **Labor Protection**

The interests of UP and MER employees will be protected by the conditions set forth in Oregon Short Line Railroad Co. – Abandonment – Goshen, 360 I.C.C. 91 (1979).

### **Certifications**

Attached as **Exhibit 2** is a Certificate of Service and Publication, pursuant to the notice requirements of 49 C.F.R §§ 1152.50(d)(1), 1105.11 and 1105.12.

### **Environmental and Historic Report**

A copy of the cover letter which accompanied the UP's Combined Environmental and Historic Report ("CEHR"), containing the information required by 49 C.F.R. §§

1105.7(e) and 1105.8, and delivered in accordance with 49 C.F.R. 1105.11, is attached as **Exhibit 3**. The CEHR was electronically filed with the Surface Transportation Board on March 27, 2024. The CEHR indicates there is one bridge on the line 50 years or older.

Since serving the CEHR, UP received correspondence from the Missouri State Historic Preservation Office ("Missouri SHPO"), the Missouri Federal Assistance Clearinghouse (Clearinghouse), and the Metropolitan St. Louis Sewer District (MSD). The Missouri SHPO has determined that no historic properties will be affected by the proposed abandonment. The Clearinghouse offered no comments or recommendations at this time. MSD has no objections as long its easement/agreement rights are retained. These letters are attached to **Exhibit 3** referenced above.

Dated April 16, 2024.

Respectfully submitted,

UNION PACIFIC RAILROAD COMPANY

MISSOURI EASTERN RAILROAD, LLC



---

Christine A. Neuharth  
Senior General Attorney  
1400 Douglas Street, MS 1580  
Omaha, NE 68179  
402-544-4764  
[caneuhar@up.com](mailto:caneuhar@up.com)

*sl Robert A. Wimbish*

---

Robert A. Wimbish  
Fletcher & Sippel LLC  
29 North Wacker Drive, Suite 800  
Chicago, IL 60606  
(312) 252-1504  
[rwimbish@fletcher-sippel.com](mailto:rwimbish@fletcher-sippel.com)

**VERIFICATION**

State of Nebraska            )  
  ) ss:  
County of Douglas         )

I, Olin H. Dirks, Manager Commercial & Interline Strategy, for Union Pacific Railroad Company declare under penalty of perjury that I have read the forgoing document and that its assertions are true and correct to the best of my knowledge, information, and belief. I further declare that I am qualified and authorized to submit this verification on behalf of Union Pacific Railroad Company.

Dated at Omaha, Nebraska, this 11<sup>th</sup> day of April, 2024.

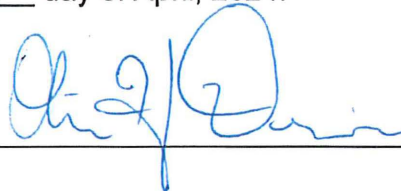
  
\_\_\_\_\_

SUBSCRIBED AND SWORN TO  
before me this 11<sup>th</sup> day of  
April, 2024.

  
\_\_\_\_\_  
Notary Public

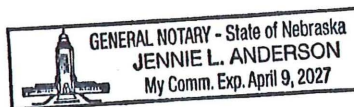

VERIFICATION

State of Missouri )  
County of Jasper ) ss:

I, John Townner, PRESIDENT, for Missouri Eastern Railroad, LLC  
declare under penalty of perjury that I have read the forgoing document and that its  
assertions are true and correct to the best of my knowledge, information, and belief. I  
further declare that I am qualified and authorized to submit this verification on behalf of  
Missouri Eastern Railroad, LLC.

Dated at Joplin, Missouri, this 16<sup>th</sup> day of April, 2024.

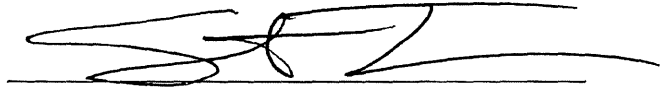

SUBSCRIBED AND SWORN TO  
before me this 16<sup>th</sup> day of  
April, 2024.

Olivia Grosdidier  
Notary Public

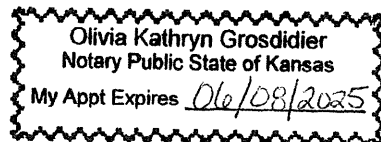



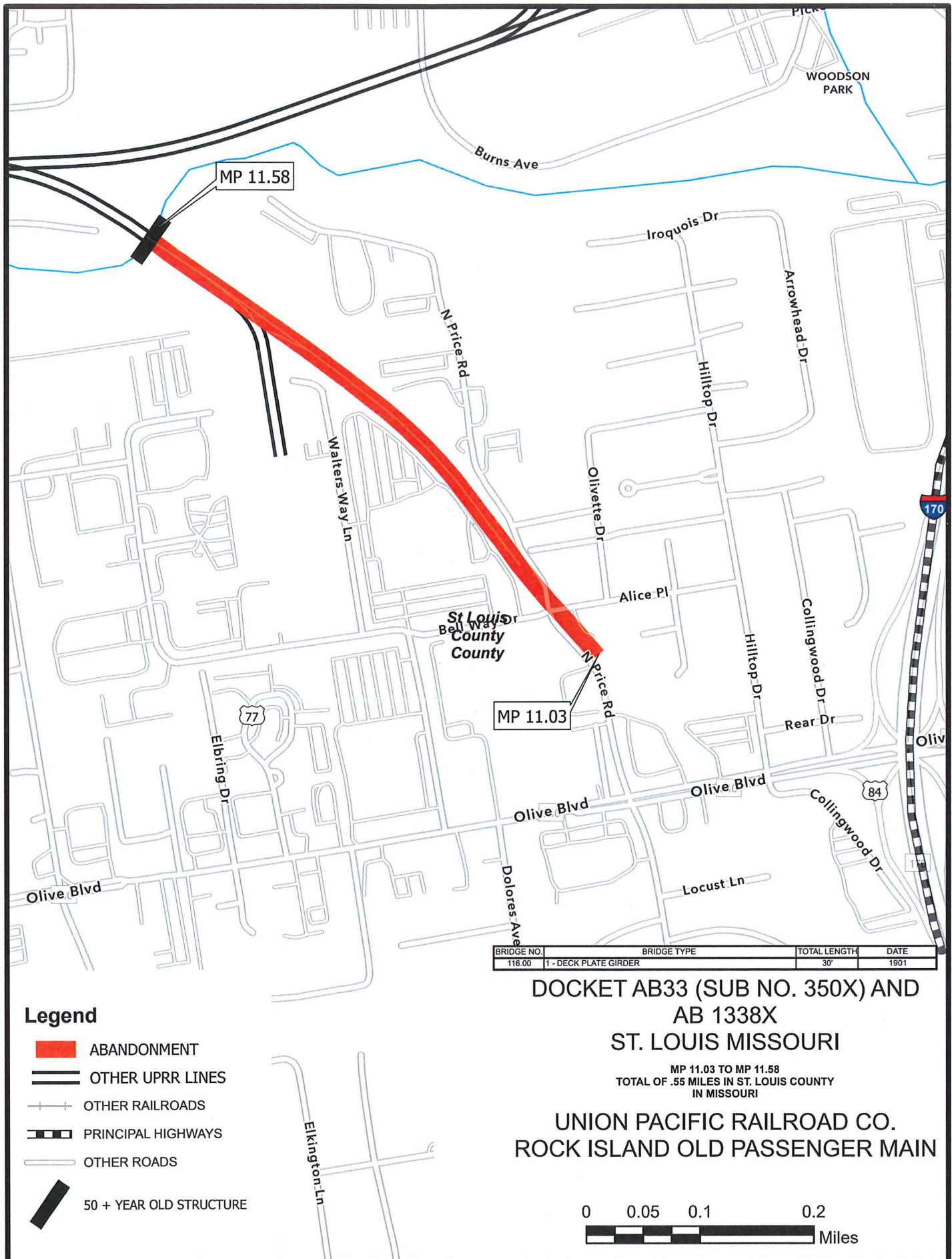

**EXHIBIT 2**

**Docket No. AB-33 (Sub-No. 350X)  
UNION PACIFIC RAILROAD COMPANY  
-- ABANDONMENT EXEMPTION --  
IN ST. LOUIS COUNTY, MO**

**Docket No. AB 1338X  
MISSOURI EASTERN RAILROAD, LLC  
-- DISCONTINUANCE OF SERVICE EXEMPTION --  
IN ST. LOUIS COUNTY, MO**

**CERTIFICATE OF SERVICE AND PUBLICATION**

**49 C.F.R. § 1152.50(d)(1) – Notice**

The undersigned certifies that on March 22, 2024, Union Pacific Railroad Company (“UP”) and Missouri Eastern Railroad, LLC (“MER”) jointly supplied written notice of their intent to use the Board’s class exemption procedures for UP to abandon, and for MER to discontinue its leasehold common carrier operations over, the Rock Island Old Passenger Main in St. Louis County, Missouri in Docket No. AB-33 (Sub-No. 350X). Said written notice (a copy of which is attached hereto as **Attachment 1**) was served on the following:

Nancy Dippell, Secretary  
Missouri Public Service Commission  
Governor Office Bldg  
200 Madison Street, PO Box 360  
Jefferson City, MO 65102-0360

ATTN: Recreation Resources Assistance  
Division  
National Park Service  
1849 C Street NW  
Washington, DC 20240

Chief of the Forest Service  
U. S. Department of Agriculture  
4<sup>th</sup> Floor, N.W. Auditors Bldg.  
1400 Independence Ave. SW  
Washington, DC 20250-0003

ATTN: Railroads for National Defense  
Program Transportation Engineering Agency  
(SDTE-SA)  
Headquarters – Military Surface Deployment &  
Distribution Command  
1 Soldier Way  
Scott AFB, IL 62225

**49 C.F.R. § 1105.11 – Transmittal Letter for Applicant’s Report**

The undersigned certifies that on March 12, 2024, Union Pacific Railroad Company served in Docket No. AB-33 (Sub-No. 350X) a Combined Environmental and

Historic Report pursuant to 49 C.F.R. § 1105.7 and 1105.8 in connection with the proposed abandonment of the Rock Island Old Passenger Main in St. Louis County, Missouri, on the following:

- (1) State Clearinghouse (or alternate)
- (2) State Environmental Protection Agency
- (3) Head of each County
- (4) U.S. Environmental Protection Agency, Regional Office
- (5) U.S. Fish and Wildlife Service
- (6) U.S. Army Corps of Engineers
- (7) National Park Service
- (8) U.S. Natural Resources Conservation Service
- (9) The National Geodetic Survey
- (10) Other Agencies Consulted (As Listed)
- (11) State Historic Preservation Office

(The Certificate of Service attached to the cover letter which accompanied UP's Combined Environmental Historic Reports lists the names and addresses of the federal, state and local agencies.)

**49 C.F.R. § 1105.12 – Newspaper Notice**

The undersigned further certifies that UP and MER arranged for a joint "Notice of Intent to Abandon and Discontinue Service" to be published in the form prescribed by the Board for a Notice of Exemption (Copy Attached as **Attachment 2**). The Notice was published one time in a major newspaper in the county in which the Line is located as follows:

<u>County</u>	<u>Newspaper</u>	<u>Date</u>
St. Louis	St. Louis Post-Dispatch	March 27, 2024

Dated this 16th day of April, 2024.

  
\_\_\_\_\_  
Christine A. Neuharth  
Senior General Attorney  
1400 Douglas Street, MS 1580  
Omaha, NE 68179  
402-544-4764  
[caneuhar@up.com](mailto:caneuhar@up.com)





BUILDING AMERICA®

March 22, 2024

Nancy Dippell, Secretary  
Missouri Public Service Commission  
Governor Office Building  
200 Madison Street, PO Box 360  
Jefferson City, MO 65102-0360

ATTN: Recreation Resources Assistance Division  
National Park Service  
1849 C Street NW  
Washington, DC 20240-0001

Chief of the Forest Service  
U. S. Department of Agriculture  
4<sup>th</sup> Floor, N.W. Auditors Bldg.  
1400 Independence Ave. SW  
Washington, DC 20250-0003

ATTN: Railroads for National Defense Program  
Transportation Engineering Agency (SDTE-SA)  
Headquarters – Military Surface Deployment &  
Distribution Command  
1 Soldier Way  
Scott AFB, IL 62225-5006

**Re: Proposed Abandonment of the Rock Island Old Passenger Main near Olivette, St. Louis County, MO, STB Docket No. AB-33 (Sub-No. 350X), Union Pacific Railroad Company**

**Proposed Discontinuance of Service on the Rock Island Old Passenger Main near Olivette, St. Louis County, MO, STB Docket No. AB 1338X, Missouri Eastern Railroad, LLC**

To Whom It May Concern:

Please be advised that Union Pacific Railroad Company ("UP") and Missouri Eastern Railroad, LLC expect to file with the United States Surface Transportation Board ("STB"), on or after April 1, 2024, a Notice of Exemption seeking authority to abandon and discontinue service over a line segment known generally as the Rock Island Old Passenger Main near Olivette, MO, extending from Milepost 11.58 to Milepost 11.03 a total distance of approximately 0.55 miles in St. Louis County, Missouri (the "Line"). The Line traverses U.S. Postal Service Zip Code 63132.

The "no business" exemption procedure will be used to abandon the Line, pursuant to the STB's abandonment regulations at 49 C.F.R. §1152.50. No local traffic has moved over the Line for at least two years and there is no overhead traffic on the Line. A Notice of Exemption to abandon and discontinue service on the Line pursuant to 49 C.F.R. § 1152.50 (no local traffic for at least two years) will be filed with the STB on or after April 1, 2024.

Based on information in UP's possession, the Line does not contain federally granted rights-of-way. Any documentation in UP's possession will be made available promptly to those requesting it. A map showing the segment of Line to be abandoned is attached for your information.

Sincerely,

*s/ Christine A. Neuharth*

Christine A. Neuharth  
Senior General Attorney  
1400 Douglas St, MS1580  
Omaha, NE 68179  
402-544-4764 (Tel.)  
caneuhar@up.com

Attachment

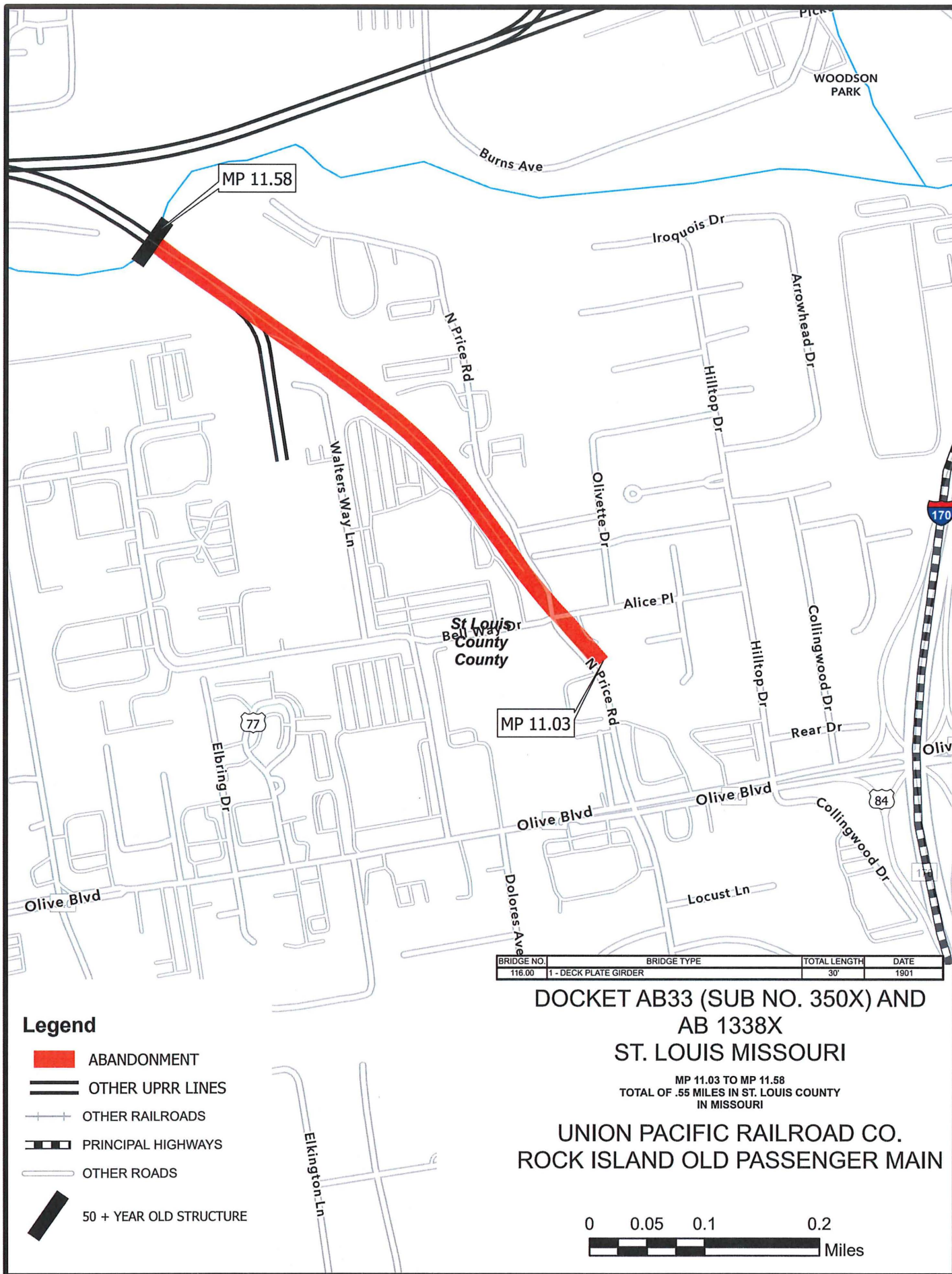





# ST. LOUIS POST-DISPATCH

## AFFIDAVIT OF PUBLICATION

Union Pacific Railroad-Law Dept  
1400 Douglas St., Mail Stop 1580  
Omaha, NE 68179  
Attn: Lori Casey (Affidavit Enclosed)

Ad Number – 128480 – PO# Lori Casey - Description: NOTICE OF INTENT TO ABANDON AND DISCONTINUE RAIL SERVICE...

THE ATTACHED ADVERTISEMENT WAS PUBLISHED

### NOTICE OF INTENT TO ABANDON AND DISCONTINUE RAIL SERVICE

UNION PACIFIC RAILROAD  
COMPANY (UP) AND MISSOURI  
EASTERN RAILROAD, LLC

(MER) GIVE NOTICE THAT ON OR AFTER April 1, 2024, they intend to file with the Surface Transportation Board, Washington, D.C., a joint notice of exemption under 49 C.F.R. Part 1152, Subpart F - Exempt Abandonments to permit, respectively, UP's abandonment of the Rock Island Old Passenger Main extending from Milepost 11.58 to 11.03 a total distance of 0.55 miles near Olivette, in St. Louis County, Missouri (the "Line") which traverses U.S. Postal Service ZIP Code 63132, and for MER's discontinuance of common carrier operations over the Line. The UP and MER proceedings have been docketed as Nos. AB-33 (Sub-No. 350X) and AB 1338X, respectively.

The Board's Office of Environmental Analysis (OEA) will generally prepare an Environmental Assessment (EA) in connection with UP's proposed abandonment of the Line, which will normally be available 25 days after the filing of the notice of exemption. Comments on environmental and energy matters should be filed no later than 15 days after the EA becomes available to the public and will be addressed in a Board decision. Interested persons may obtain a copy of the EA or make inquiries regarding environmental matters by writing to the Office of Environmental Analysis (OEA), Surface Transportation Board, 395 E Street, SW, Washington, DC 20423 or by calling that office at (202) 245-0291.

In the St. Louis Post-Dispatch on the following date(s): 3/27/2024

A version of the ad also appeared on STLtoday.com Starting: 3/27/2024

Appropriate offers of financial assistance to continue rail service can be filed with the Board. Requests for environmental conditions, public use conditions, or rail banking/trails use also can be filed with the Board. An original and 10 copies of any pleading that raises matters other than environmental issues (such as trails use, public use, and offers of financial assistance) must be filed directly with the Board's Office of Proceedings, 395 E Street, SW, Washington, DC 20423 [See 49 CFR 1104.1(a) and 1104.3(a)], and one copy must be served on the applicant's representative. [See 49 CFR 1104.12(a)]. Questions regarding offers of financial assistance, public use or trails use may be directed to the Board's Office of Public Assistance.

*Lori Casey - Manager*  
COMPANY REPRESENTATIVE

SWORN TO AND SUBSCRIBED BEFORE ME  
THIS 4/2, 2024

*Madeline Keller*  
NOTARY PUBLIC, CITY OF ST. LOUIS

901 N. TENTH ST., ST LOUIS MO 63101

PHONE 314-340-8000

MADELINE KELLER  
Notary Public - Notary Seal  
St. Louis City - State of Missouri  
Commission Number 19569759  
My Commission Expires Mar 19, 2027



**BUILDING AMERICA®**

**EXHIBIT 3**

AB\_33\_350\_X  
AB\_1338\_0\_X

308137

ENTERED  
Office of Proceedings  
March 27, 2024  
Part of  
Public Record

March 12, 2024

**VIA US Mail**

**TO: See Attached Service List**

**Re: Proposed Abandonment of the Rock Island Old Passenger Main near Olivette, St. Louis County, MO, STB Docket No. AB-33 (Sub-No. 350X), Union Pacific Railroad Company**

**Proposed Discontinuance of Service on the Rock Island Old Passenger Main near Olivette, St. Louis County, MO, STB Docket No. AB 1338X, Missouri Eastern Railroad, LLC**

To Whom It May Concern:

On or after April 1, 2024, Union Pacific Railroad Company ("UP") and Missouri Eastern Railroad, LLC expect to be filing with the Surface Transportation Board ("STB" or "Board") a Notice of Exemption seeking authority to abandon and discontinue service over a line segment known generally as the Rock Island Old Passenger Main near Olivette, Missouri, extending from Milepost 11.58 to Milepost 11.03, a total distance of approximately 0.55 miles in St. Louis County, Missouri ("the Line"). Attached is a Combined Environmental and Historic Report describing the proposed action and any expected environmental and historic effects, as well as a map of the affected area.

Union Pacific is providing this report so that you may review the information that will form the basis for the STB's independent environmental analysis of this proceeding. If any of the information is misleading or incorrect, if you believe that pertinent information is missing, or if you have any questions about the Board's environmental review process, please contact the Office of Environmental Analysis (OEA), Surface Transportation Board, Washington, DC, telephone (202) 245-0291 and refer to the above Docket Nos. Because the applicable statutes and regulations impose stringent deadlines for processing this action, your written comments to OEA (with a copy to our representative) would be appreciated within three weeks.

Your comments will be considered by the Board in evaluating the environmental and/or historic preservation impacts of the contemplated action. If there are any questions concerning this proposal, please contact our representative directly. Our representative in this matter is Christine A. Neuharth who may be contacted by telephone at 402-544-4764 or by mail at 1400 Douglas Street, MS 1580, Omaha, NE 68179.

Sincerely,

s/ Christine A. Neuharth

Christine A. Neuharth, Sr. General Attorney  
Union Pacific Railroad Company  
1400 Douglas Street, MS 1580  
Omaha, Nebraska 68179  
(402) 544-4764  
[caneuhar@up.com](mailto:caneuhar@up.com)

Attachment

**STB Docket No. AB-33 (Sub-No. 350X) and Docket No. AB 1338X**

**Service List**

**State Clearinghouse (or Alternate):**

Missouri Federal Assistance Clearinghouse  
Office of Administration  
Missouri State Capitol Building, Room 125  
201 West Capitol Avenue, P.O. Box 809  
Jefferson City, MO 65102

**U.S. Army Corps of Engineers:**

Headquarters  
U.S. Army Corps of Engineers  
441 G Street NW  
Washington, DC 20314-1000

Department of the Army  
St. Louis District, Corps of Engineers  
1222 Spruce Street  
St. Louis, Missouri 63103-2833

**State Environmental Protection Agency:**

Division of Environmental Quality  
1101 Riverside Drive  
P.O. Box 176  
Jefferson City, MO 65102-0176

**National Park Service:**

National Park Service  
1849 C Street NW  
Washington, DC 20240

**Environmental Protection Agency (Regional Office):**

U.S. Environmental Protection Agency, Region 7  
11201 Renner Boulevard  
Lenexa, KS 66219

**U.S. Natural Resources Conservation Service:**

Terry Cosby, Chief  
Natural Resource Conservation Service  
1400 Independence Ave.  
Washington, DC 20250

**State of Missouri Historic Preservation Office:**

Tammy Boesch  
Missouri SHPO Review, Compliance, and Records  
Missouri Dept of Natural Resources  
1659 E Elm St, P.O. Box 176  
Jefferson City, MO 65102

**National Geodetic Survey:**

NGS Information Services, NOAA, N/NGS12  
Geodetic Services Division SSMC-3 #9340  
1315 E-W Highway  
Silver Spring, Maryland 20910-3282  
[RRAE@noaa.gov](mailto:RRAE@noaa.gov)

**U.S. Fish and Wildlife Service:**

Martha Williams, Director  
U.S. Fish and Wildlife Service  
1849 C Street, NW  
Washington, DC 20240

**Head of St. Louis County, Missouri:**

Dr. Sam Page, County Executive, St. Louis County  
41 South Central  
Clayton, MO 63105

Stephanie Leon Streeter, PE  
Director, Dept of Transportation & Public Works  
1050 North Lindbergh  
St. Louis, MO 63132

**Metropolitan St. Louis Sewer District**

2350 Market Street  
St. Louis, MO 63103



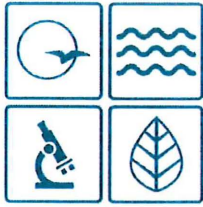

**MISSOURI**  
**DEPARTMENT OF**  
**NATURAL RESOURCES**

**Michael L. Parson**  
Governor

**Dru Buntin**  
Director

April 1, 2024

Christine A. Neuharth  
Union Pacific Railroad Company  
1400 Douglass Street, MS 1580  
Omaha, NE, 68179

**Re: SHPO Project Number: 002-SL-24** — STB Docket Nos. AB-33\_350X and AB 1338X,  
Abandonment & Discontinuance, Rock Island Old Passenger Main, Milepost 11.58 to Milepost  
11.03, Rock Island Old Passenger Main, Olivette, St. Louis County, Missouri (STB)

Dear Christine A. Neuharth:

Thank you for submitting information to the State Historic Preservation Office (SHPO) regarding the above-referenced project for review pursuant to Section 106 of the National Historic Preservation Act, P.L. 89-665, as amended (NHPA), and the Advisory Council on Historic Preservation's regulation 36 CFR Part 800, which require identification and evaluation of historic properties.

We have reviewed the information regarding the above-referenced project and have included our comments on the following page(s). Please retain this documentation as evidence of consultation with the Missouri SHPO under Section 106 of the NHPA. SHPO concurrence does not complete the Section 106 process as federal agencies will need to conduct consultation with all interested parties. **Please be advised that, if the current project area or scope of work changes, such as a borrow area being added, or cultural materials are encountered during construction, appropriate information must be provided to this office for further review and comment.**

If you have questions please contact the SHPO at (573)751-7858 or call/email Charles Horton (573) 526-4591, [charles.horton@dnr.mo.gov](mailto:charles.horton@dnr.mo.gov). If additional information is required please submit the information via email to [MOSection106@dnr.mo.gov](mailto:MOSection106@dnr.mo.gov).

Sincerely,

STATE HISTORIC PRESERVATION OFFICE

Brian Stith  
Deputy Director Division of State Parks  
Deputy Missouri State Historic Preservation Officer



April 1, 2024  
Christine A. Neuharth  
Page 2 of 2

**SHPO Project Number: 002-SL-24** — STB Docket Nos. AB-33\_350X and AB 1338X,  
Abandonment & Discontinuance, Rock Island Old Passenger Main, Milepost 11.58 to Milepost 11.03,  
Rock Island Old Passenger Main, Olivette, St. Louis County, Missouri (STB)

---

COMMENTS:

Adequate documentation has been provided as outlined in 36 CFR Section 800.11. After review of the initial submission, the project area has no known historic properties present and a low potential for the occurrence of cultural resources. SHPO concurs with your determination of **no historic properties affected**.



**Michael L. Parson**  
Governor

State of Missouri  
**OFFICE OF ADMINISTRATION**  
Post Office Box 809  
Jefferson City, Missouri 65102  
Phone: (573) 751-1851

**Kenneth J. Zellers**  
Commissioner

April 2, 2024

Christine Neuharth  
1400 Douglas Street  
Omaha, NE 68179

Subject: 2409042  
Legal Name: Union Pacific Railroad Co  
Agency:  
Project Description: proposed Abandonment of the Rock Island Old Passenger Main near Olivette, St. Louis County, MO, STB Docket No. AB-33 (Sub-No. 350X), Union Pacific Railroad Company / Proposed Discontinuance of Service on the Rock Island Old Passenger Main near Olivette, S

The Missouri Federal Assistance Clearinghouse, in cooperation with state and local agencies interested or possibly affected, has completed the review on the above project application.

None of the agencies involved in the review had comments or recommendations to offer at this time. This concludes the Clearinghouse's review.

A copy of this letter is to be attached to the application as evidence of compliance with the State Clearinghouse requirements.

Sincerely,

A handwritten signature in blue ink that reads "Sara VanderFeltz".

Sara VanderFeltz  
Administrative Assistant

cc:





**Metropolitan  
St. Louis Sewer  
District**

2350 Market Street  
St. Louis, MO 63103-2555  
(314) 768-6200

March 15, 2024,

Christine A. Neuharth, Sr. General Attorney  
Union Pacific Railroad Company  
1400 Douglas Street, MS 1580  
Omaha, Nebraska 68179

Re: **Proposed Abandonment of the Rock Island Old Passenger Main near Olivette, St. Louis County, Mo, STB Docket No. AB-33(Sub-No. 350X), Union Pacific Railroad Company**

**Proposed Discontinuance of Service Rock Island Old Passenger Main near Olivette, St. Louis County, Mo, STB Docket No. AB 1338X, Missouri Eastern Railroad, LLC.**

Ms. Neuharth,

This letter is in response to the request for MSD comment based on Saint Louis County Transportation and Public works letter, dated February 22, 2024, pertaining to the above proposed abandonment and discontinuance of service request. MSD has no objections as it relates to the abandonment and discontinuance of services as long as MSD's easement/agreement rights are retained to allow access and maintenance of existing MSD assets. MSD has active public sewers in the area. If in the future, the parcel(s) is re-developed, formal plans are required to be submitted to MSD for review. Stormwater water quality and quantity management may be required in accordance with our region's MS4 Permit and MSD Rules and Regulations in effect at the time of the redevelopment.

With regards to environmental protection and hazardous waste spills, the U.S. Environmental Protection Agency and Missouri Department of Natural Resources would have jurisdiction. Discharge of waters and wastes from the site into MSD's wastewater system, stormwater system, drainage facilities, watercourses, and outfalls are required to comply with MSD's Ordinance No. 15048.

Sincerely,

A handwritten signature in black ink, appearing to read 'Mark Kuelker', is written over a horizontal line.

Mark Kuelker, P.E.  
MSD Engineering / Planning – Development Review